

W:\001\Projects\0710\0710.dwg, CA Floor Plan, 2/22/2011 8:54:50 AM, 12:12

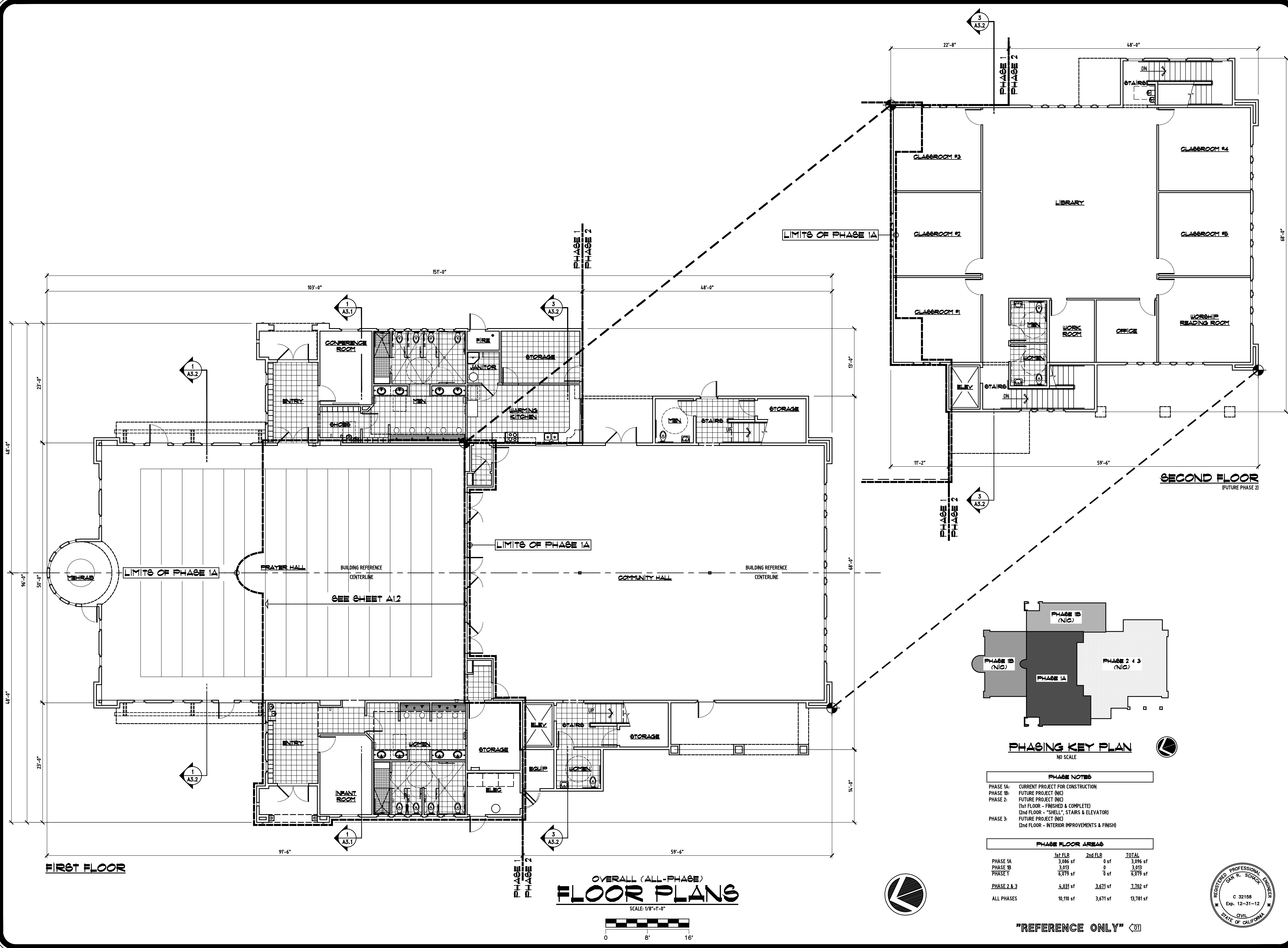

**OVERALL (ALL-PHASE)
FLOOR PLANS**

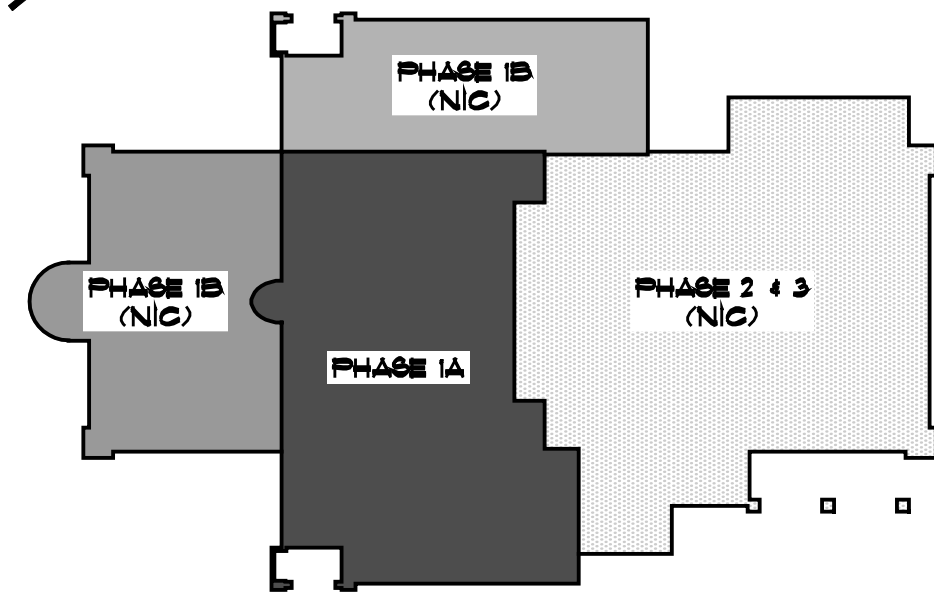
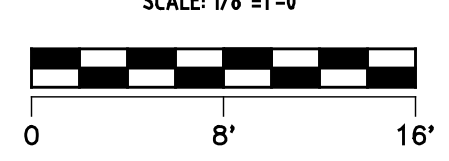

PHASING KEY PLAN
NO SCALE

- PHASE NOTES**
- PHASE 1A: CURRENT PROJECT FOR CONSTRUCTION
 - PHASE 1B: FUTURE PROJECT (NIC)
 - PHASE 2: FUTURE PROJECT (NIC)
(1st FLOOR - FINISHED & COMPLETE)
(2nd FLOOR - "SHELL", STAIRS & ELEVATOR)
 - PHASE 3: FUTURE PROJECT (NIC)
(2nd FLOOR - INTERIOR IMPROVEMENTS & FINISH)

PHASE FLOOR AREAS			
	1st FLR	2nd FLR	TOTAL
PHASE 1A	3,086 sf	0 sf	3,086 sf
PHASE 1B	3,013	0	3,013
PHASE 2	6,079 sf	0 sf	6,079 sf
PHASE 2 & 3	4,031 sf	3,671 sf	7,702 sf
ALL PHASES	10,110 sf	3,671 sf	13,781 sf

"REFERENCE ONLY"



DATE	REVISIONS	BY	APP'D BY
08/17/12	1	SFS	SFS
	2	SFS	SFS
	3	SFS	SFS

**PHASE 1A
BUILDING & SITE IMPROVEMENTS**

Dariseed Islamic Mosque
Tracy Islamic Center
21400 S. CORRAL HOLLOW ROAD
TRACY, CALIFORNIA 95304

DRAWING RELEASE

DESCRIPTION	DATE
PRELIMINARY REVIEW	07/25/12
INITIAL PLAN REVIEW	07/25/12
REV. DOCUMENTS	07/25/12
FINAL CONSTRUCTION	07/25/13

Schack & Company, Inc.

Civil Engineering • Building Design • Surveying
(909) 856-2178 • P.O. Box 339 • Tracy, California 95376 • FAX (909) 856-1468

DATE	11/29/11
DRAWN BY	SFS
CHECKED BY	SFS
JOB NO.	07.047
A1.1	
OF 77 SHEETS	